



RP. ATEX Push buttons

Protection mode:

Type of protection: II 2 GD - EEx d IIC
 Class of temperature: T6 / 85°C
 Protection degree: IP 65 / IP 67*

Description:

The push button type RP1 has a body . 1 h ISO 228 to be screwed to one entry; couplings fixed by loctite or similar. Complete with contacts.

Push button applicable on EJB, GUB, EFD boxes and EExd certificated enclosures.



Technical data:

On request:

*Protection cap for IP 67.
 Additional contacts (1NO and/or 1NC).
 Neutral label.

Technical drawing:

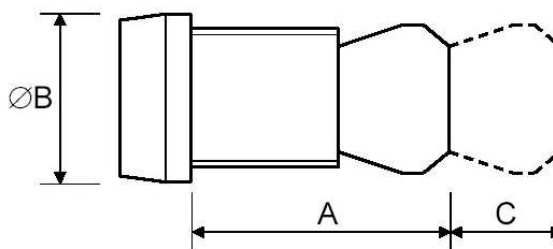

Dimensions table:

Type	Contacts	Rated current (A)	Rated voltage (V)	Dimensions (mm)			Available colours	Available labels	
				Thread	A	B			C
RP1.01	1 NC	2,5 A	400 V	1" ISO 228	62	40	26	Black Red Green Blue Yellow White	"MARCIA" "ARRESTO"
RP1.02	2 NC								
RP1.11	1 NO + 1 NC								
RP1.10	1 NO								
RP1.20	2 NO	10 A	24 V	1/2" ISO 228	62	25	26	Black Red Green Blue Yellow	"MARCIA" "ARRESTO" "START" "STOP"
RP2.01	1 NC								
RP2.02	2 NC								
RP2.11	1 NO + 1 NC								
RP2.10	1 NO	10 A	24 V	1/2" ISO 228	62	25	26	Black Red Green Blue Yellow	"MARCIA" "ARRESTO" "START" "STOP"
RP2.20	2 NO								