



## ELF Elbow 90°

### Protection mode:

Type of protection: II 2 G EEx d IIC  
 Class of temperature: T6  
 Protection degree:   
 Certificate: CESI 01 ATEX 104U



### Description:

The ELF elbows are composed by aluminium alloy body with two threaded entries assembled at 90°. In order to obtain one (ELMF) of two male ends (ELM), it is necessary to screw on the entries one or two nipples NP type. The ELF elbows are used in equipments to change the direction of pipes.

### Technical data:

#### Materials:

Body: aluminium alloy.

#### Thread:

UNI 6125 (ISO 7/1).

#### On request:

Other types of threads.

### Technical drawing:

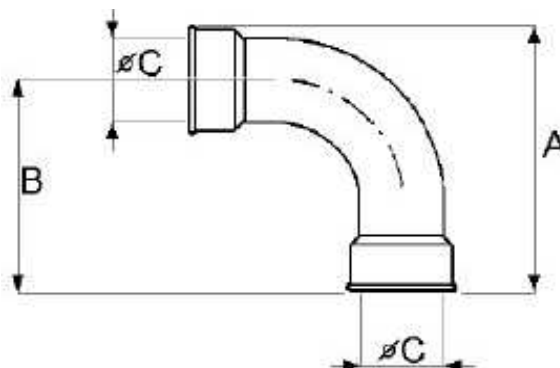

Type	Sizes (mm)		
	Ø C	B	A
ELF 1	1/2"	57	72
ELF 2	3/4"	57	72
ELF 3	1"	70	92
ELF 4	1.1/4"	85	112
ELF 5	1.1/2"	85	112
ELF 6	2"	100	135
ELF 7	2.1/2"	115	157
ELF 8	3"	135	185
ELF 10	4"	150	222