



PLG/PG Plug PG in polyamide

Protection mode:

Type of protection: II 2 GD EEx e II
Class of temperature:
Protection degree: IP 66 / IP 68*
Certificate: LCIE 98 ATEX 0001U



Description:

The plugs series PLG/PG allow the closing of entries on EExe enclosures.
Closing of entries on enclosures, junction boxes, and so on...

Technical data:

Materials:

Body: polyamide black colour, RAL 9005.

On request:

*Sealing gasket (IP 68).
Counter-nut.
Metric thread (ISO Mx1.5).

Technical drawing:

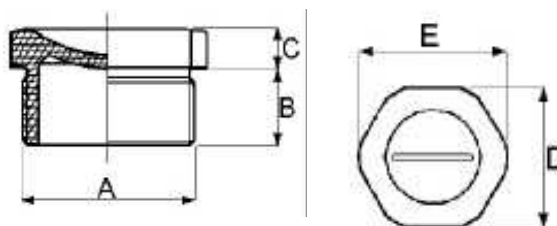

Type	Thread Ø A	Sizes (mm)			
		B	C	D	E
PLG / PG 07	PG 7	8	4.0	15	16.5
PLG / PG 09	PG 9	10	4.5	19	20.9
PLG / PG 11	PG 11	10.5	4.5	22	24.2
PLG / PG 13	PG 13.5	11	5.0	24	26.4
PLG / PG 16	PG 16	12	5.0	27	29.7
PLG / PG 21	PG 21	12.5	5.5	32	35.2
PLG / PG 29	PG 29	13.5	5.5	40	44.0
PLG / PG 36	PG 36	15	6.0	54	59.4
PLG / PG 42	PG 42	15	6.5	59	64.9
PLG / PG 48	PG 48	15.5	6.5	64	70.4