

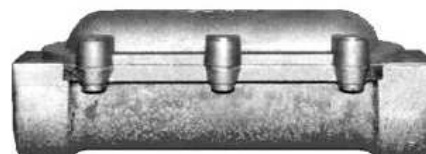

## EKC Pulling fittings

### Protection mode:

Type of protection: II 2 G - EEx d IIB  
 Class of temperature: T6



### Description:

The EKC fittings consist of a body having two threaded entries and of a cover, with flat joint, fixed by screws.

The EKC fittings are used to facilitate the insertion of not very flexible cables or of big sections and to connect pipes.

### Technicals data:

#### Materials:

Body and cover: aluminium alloy.  
 Screws: galvanized steel.

#### On request:

Other types of thread.

### Technical drawing:

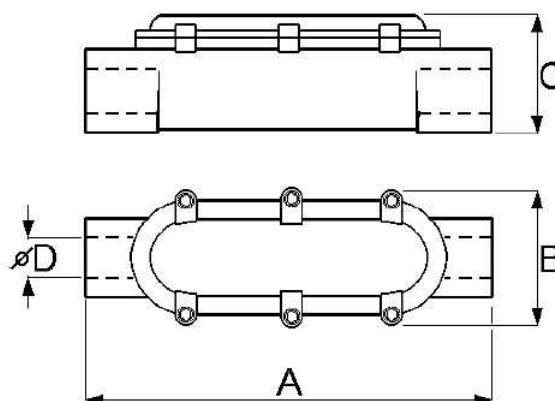

Type	Entries UNI 6125	Dimensions (mm)		
	Ø D	A	B	C
EKC 1	1/2"	173	70	60
EKC 2	3/4"	173	70	60
EKC 3	1"	183	70	67
EKC 4	1.1/4"	243	102	90
EKC 5	1.1/2"	243	102	90
EKC 6	2"	300	104	112
EKC 7	2.1/2"	380	138	174
EKC 8	3"	380	138	174
EKC 10	4"	750	185	200